

CORTEO

CTO

COLUMBIA 3

150 SERIES (HEAVY APPLICATIONS)

GRIP: HARWOOD WITH SLEEVES (SLV)

MOUNT: STRAIGHT (S)

MOUNT MATERIAL: BRASS (BR)

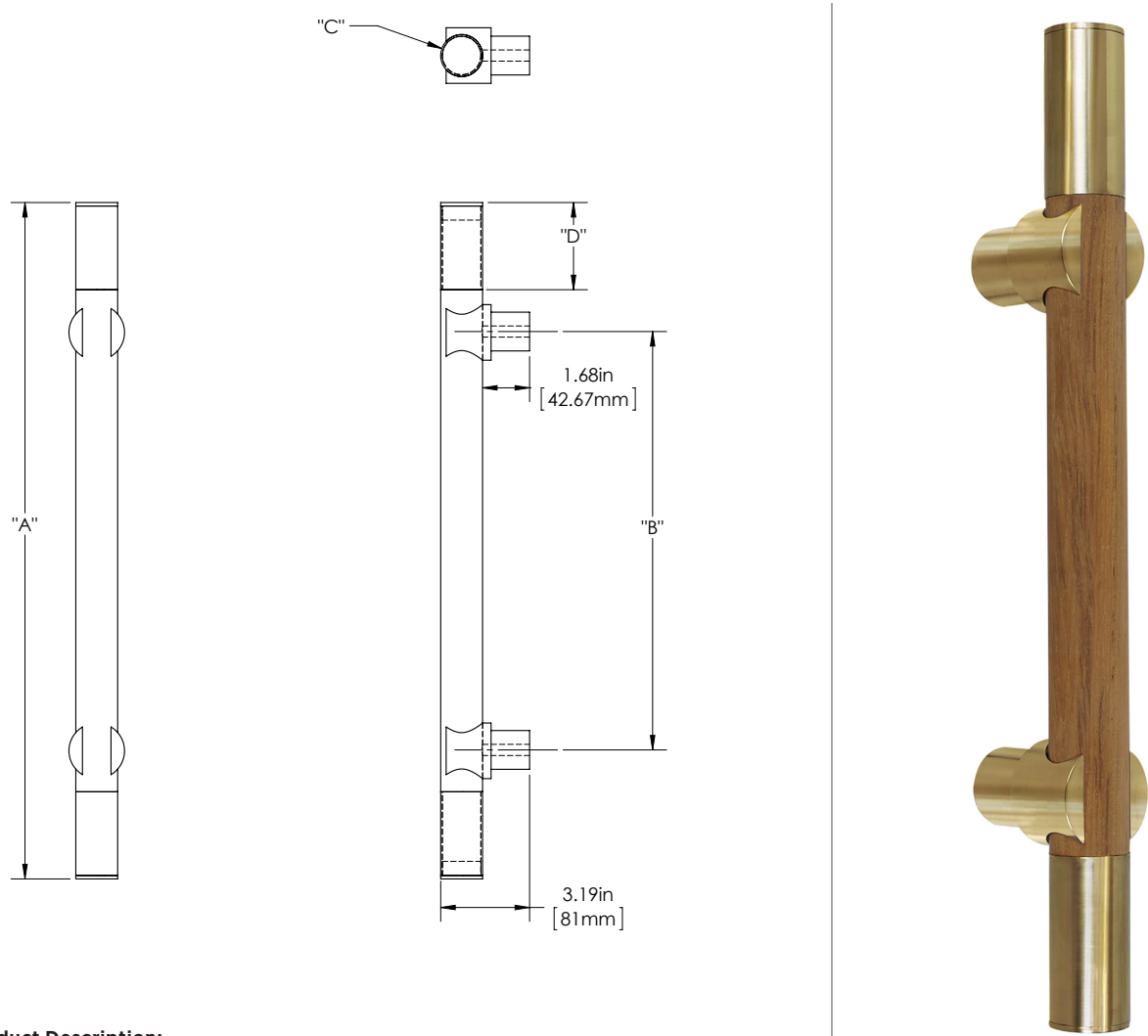

Product Description:
1 1/2" Solid Round Wood Grip with Sleeves and Sigma Mounts

Material:
Grip - Hardwood
Mount(s) - Brass

Finish Description:
Grip - Cherry, Bubinga, Ipe, Jatoba, Mahogany, White Oak, Teak, Black Walnut
Mount(s) - US11, AGB Aged Brass; US5, ATB Antique Brass; US3, PLB Polished Brass; US4, SNB Satin Brass; US10B, ORB Oil Rubbed Bronze; US26, PLC Polished Chrome; US26D, SNC Satin Chrome; US14, PLN Polished Nickel; US15, SNN Satin Nickel; US19, MBK Matte Black PC; US10B, LTH Lithonia PC

Custom sizes & finishes available upon request.
*Recommended 3rd additional bracket for longer length.

Overall Length "A"	Center To Center "B"	Overall Diameter "C"	Sleeve Length "D"
18"(457mm)	10"(254mm)	1 1/2"(38mm)	3"(76mm)
24"(610mm)	15"(381mm)	1 1/2"(38mm)	3"(76mm)
36"(914mm)	27"(686mm)	1 1/2"(38mm)	3"(76mm)
48"(1219mm)	36"(914mm)	1 1/2"(38mm)	3"(76mm)
60"(1524mm)	48"(1219mm)	1 1/2"(38mm)	4 1/2"(114mm)
72"(1829mm)	60"(1524mm)	1 1/2"(38mm)	4 1/2"(114mm)
84"(2134mm)	72"(1829mm)	1 1/2"(38mm)	6"(152mm)
*96"(2438mm)	72"(1829mm)	1 1/2"(38mm)	6"(152mm)

CORTEO

CTO

COLUMBIA 4

150 SERIES (HEAVY APPLICATIONS)

GRIP: HARWOOD WITH SLEEVES (SLV)

MOUNT: STRAIGHT (S)

MOUNT MATERIAL: STAINLESS STEEL 304 (S4)

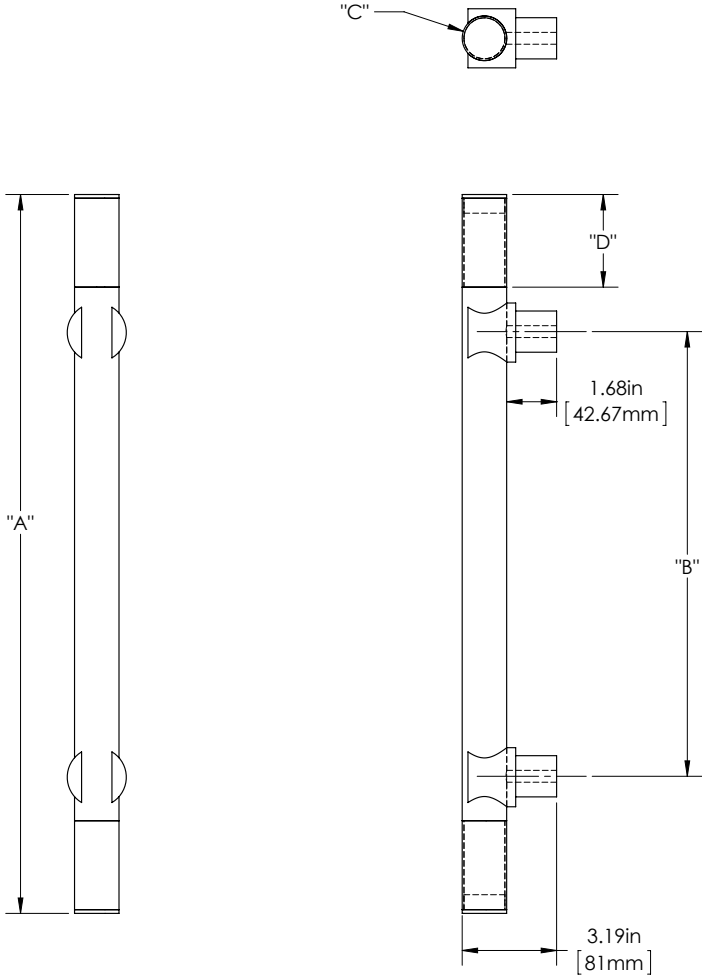

Product Description:

1 1/2" Solid Round Wood Grip with Sleeves and Sigma Mounts

Material:

Grip - Hardwood
Mount(s) - Stainless Steel

Finish Description:

Grip - Cherry, Bubinga, Ipe, Jatoba, Mahogany, White Oak, Teak, Black Walnut
Mount(s) - US32D, BSS Brushed Stainless; US32, PSS Polished Stainless; US19, MBK Matte Black PC; US10B, LTH Lithonia PC

Custom sizes & finishes available upon request.
*Recommended 3rd additional bracket for longer length.

Overall Length "A"	Center To Center "B"	Overall Diameter "C"	Sleeve Length "D"
18"(457mm)	10"(254mm)	1 1/2"(38mm)	3"(76mm)
24"(610mm)	15"(381mm)	1 1/2"(38mm)	3"(76mm)
36"(914mm)	27"(686mm)	1 1/2"(38mm)	3"(76mm)
48"(1219mm)	36"(914mm)	1 1/2"(38mm)	3"(76mm)
60"(1524mm)	48"(1219mm)	1 1/2"(38mm)	4 1/2"(114mm)
72"(1829mm)	60"(1524mm)	1 1/2"(38mm)	4 1/2"(114mm)
84"(2134mm)	66"(1676mm)	1 1/2"(38mm)	6"(152mm)
*96"(2438mm)	72"(1829mm)	1 1/2"(38mm)	6"(152mm)

Dimensions are approximate and provided for reference purposes only