

LOGAN

LOG

LAGUNA 5

100 SERIES (MEDIUM APPLICATIONS)

GRIP: HARDWOOD WITH SLEEVES (SLV)

MOUNT: STRAIGHT (S)

MOUNT MATERIAL: BRASS (BR)

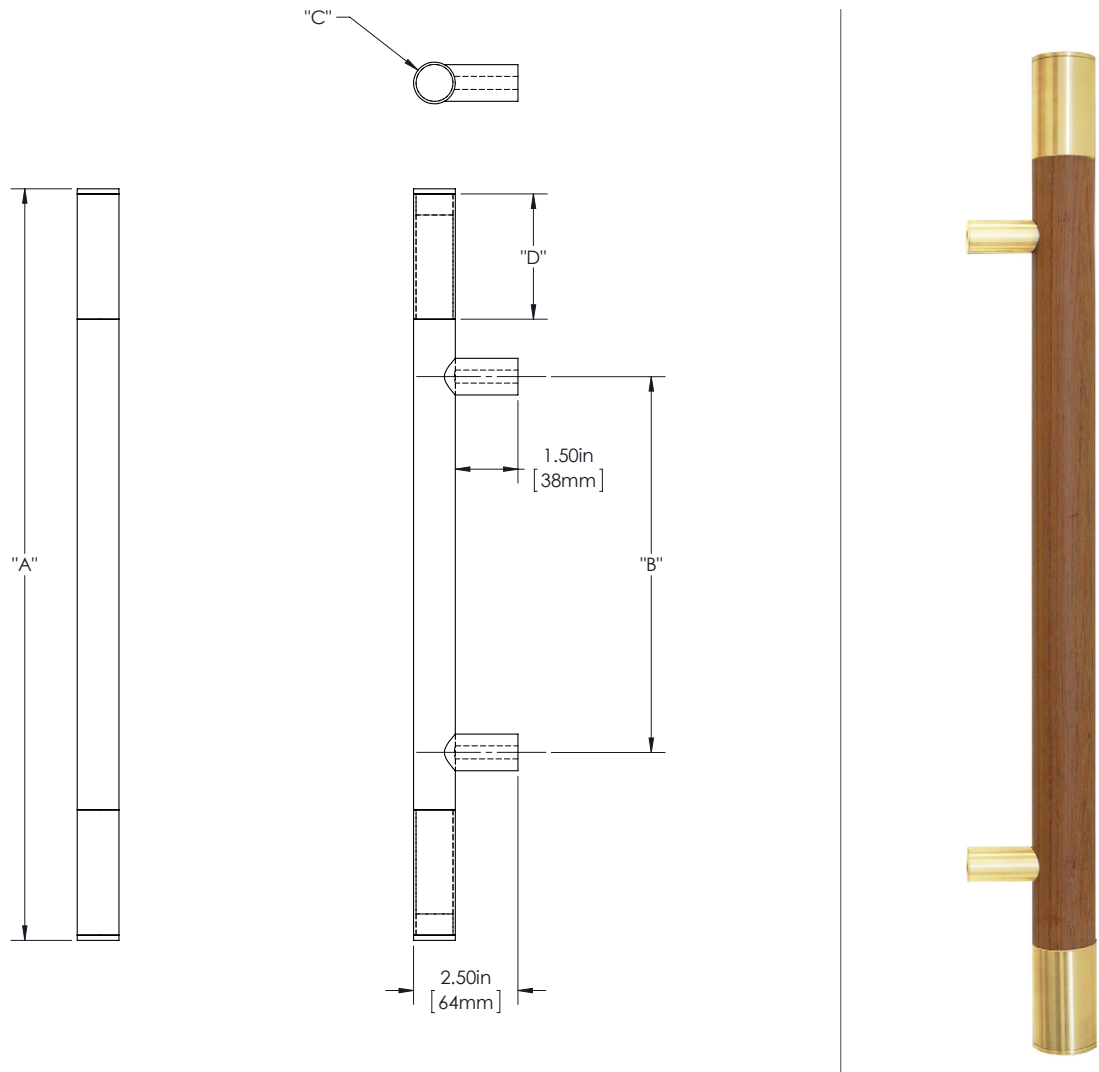

**Product Description:**  
1" Solid Round Wood Grip with Sleeves and Straight Round Mounts

**Material:**  
Grip - Hardwood  
Mount(s) - Brass

**Finish Description:**  
Grip - Cherry, Bubinga, Ipe, Jatoba, Mahogany, White Oak, Teak, Black Walnut  
Mount(s) - US11, AGB Aged Brass; US5, ATB Antique Brass; US3, PLB Polished Brass; US4, SNB Satin Brass; US10B, ORB Oil Rubbed Bronze; US26, PLC Polished Chrome; US26D, SNC Satin Chrome; US14, PLN Polished Nickel; US15, SNN Satin Nickel; US19, MBK Matte Black PC; US10B, LTH Lithonia PC

Overall Length "A"	Center To Center "B"	Overall Diameter "C"	Sleeve Length "D"
12"(305mm)	7"(179mm)	1"(25mm)	1 1/2"(38mm)
24"(610mm)	15"(381mm)	1"(25mm)	3"(76mm)
36"(914mm)	24"(610mm)	1"(25mm)	3"(76mm)
48"(1219mm)	36"(914mm)	1"(25mm)	3"(76mm)

Custom sizes & finishes available upon request.

Dimensions are approximate and provided for reference purposes only

LOGAN

LOG

LAGUNA 6

150 SERIES (HEAVY APPLICATIONS)

GRIP: HARDWOOD WITH SLEEVES (SLV)

MOUNT: STRAIGHT (S)

MOUNT MATERIAL: BRASS (BR)

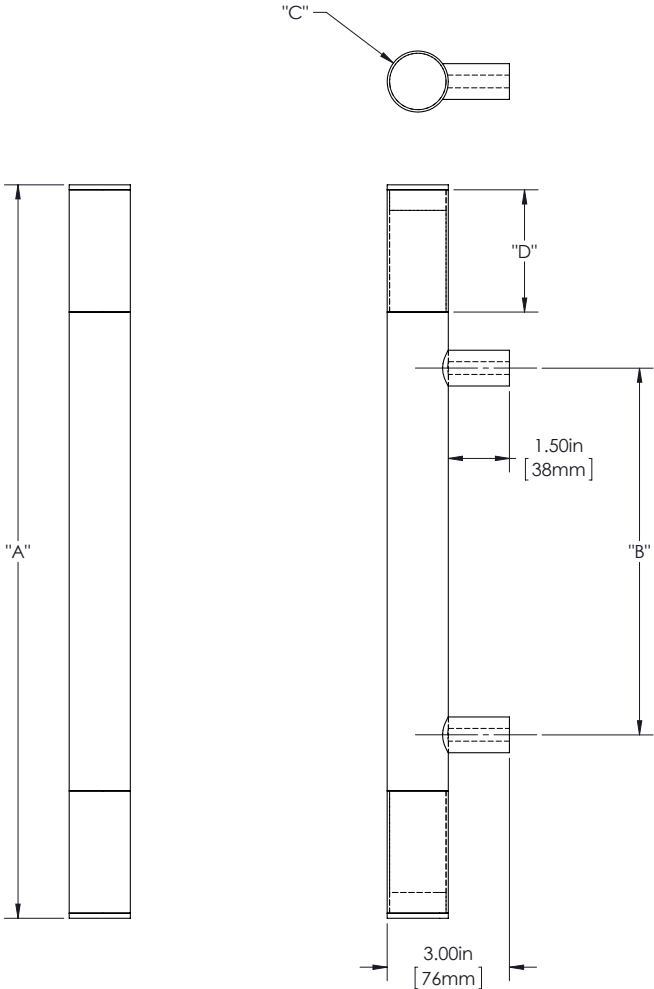

**Product Description:**  
1 1/2" Solid Round Wood Grip with Sleeves and Straight Round Mounts

**Material:**  
Grip - Hardwood  
Mount(s) - Brass

**Finish Description:**  
Grip - Cherry, Bubinga, Ipe, Jatoba, Mahogany, White Oak, Teak, Black Walnut  
Mount(s) - US11, AGB Aged Brass; US5, ATB Antique Brass; US3, PLB Polished Brass; US4, SNB Satin Brass; US10B, ORB Oil Rubbed Bronze; US26, PLC Polished Chrome; US26D, SNC Satin Chrome; US14, PLN Polished Nickel; US15, SNN Satin Nickel; US19, MBK Matte Black PC; US10B, LTH Lithonia PC

Overall Length "A"	Center To Center "B"	Overall Diameter "C"	Sleeve Length "D"
18"(457mm)	9"(229mm)	1 1/2"(38mm)	1 1/2"(38mm)
24"(610mm)	15"(381mm)	1 1/2"(38mm)	3"(76mm)
36"(914mm)	24"(610mm)	1 1/2"(38mm)	3"(76mm)
48"(1219mm)	36"(914mm)	1 1/2"(38mm)	3"(76mm)

Custom sizes & finishes available upon request.

Dimensions are approximate and provided for reference purposes only

LOGAN

LOG

LAGUNA 7

150 SERIES (HEAVY APPLICATIONS)

GRIP: HARDWOOD WITH SLEEVES (SLV)

MOUNT: STRAIGHT (S)

MOUNT MATERIAL: STAINLESS STEEL 304 (S4)

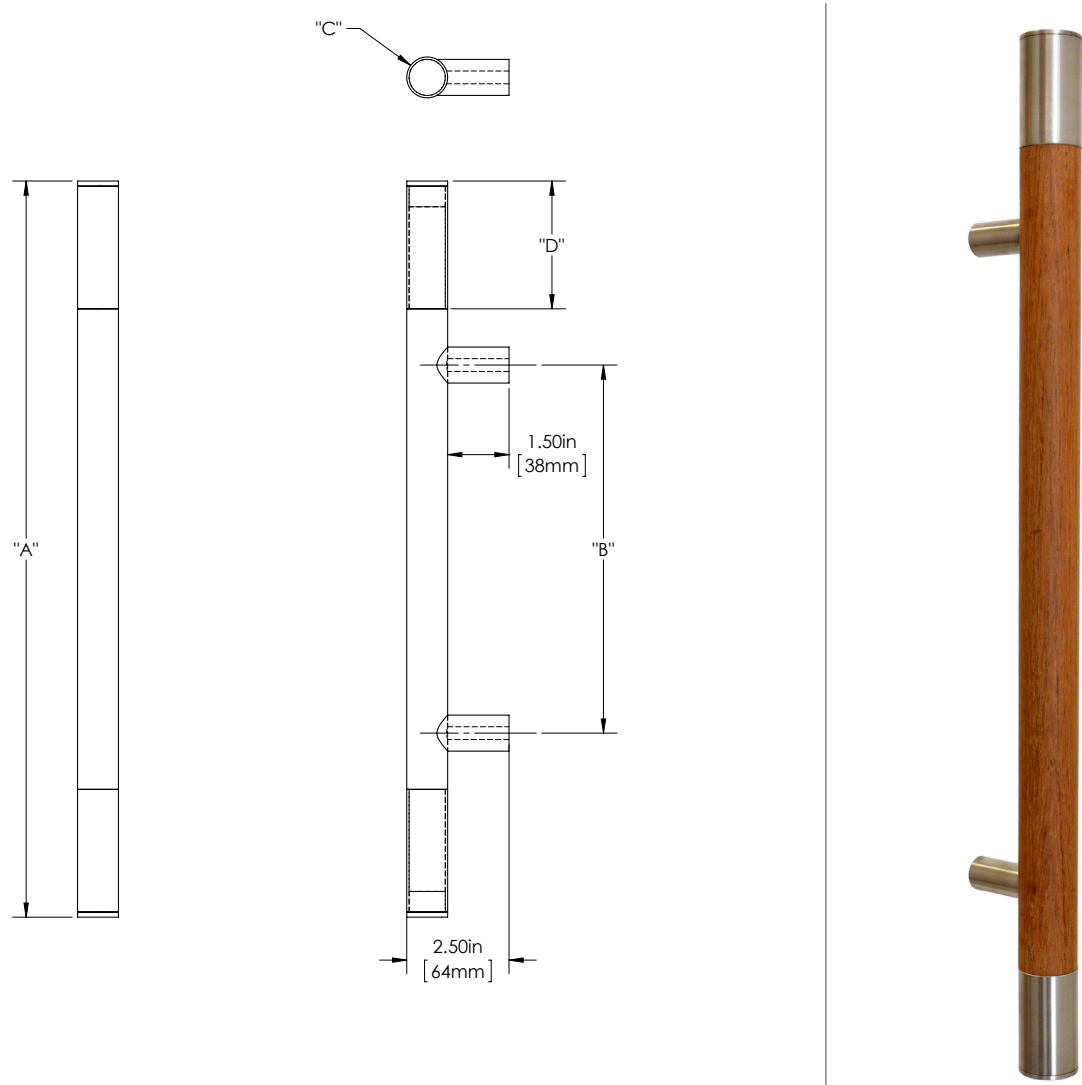

**Product Description:**  
1 1/2" Solid Round Wood Grip with Sleeves and Straight Round Mounts

**Material:**  
Grip - Hardwood  
Mount(s) - Stainless Steel

**Finish Description:**  
Grip - Cherry, Bubinga, Ipe, Jatoba, Mahogany, White Oak, Teak, Black Walnut  
Mount(s) - US32D, BSS Brushed Stainless; US32, PSS Polished Stainless; US19, MBK Matte Black PC; US10B, LTH Lithonia PC

Overall Length "A"	Center To Center "B"	Overall Diameter "C"	Sleeve Length "D"
12"(305mm)	7"(178mm)	1"(25mm)	1 1/2"(38mm)
24"(610mm)	15"(381mm)	1"(25mm)	3"(76mm)
36"(914mm)	27"(686mm)	1"(25mm)	3"(76mm)
48"(1219mm)	36"(914mm)	1"(25mm)	3"(76mm)

Custom sizes & finishes available upon request.

Dimensions are approximate and provided for reference purposes only

LOGAN

LOG

LAGUNA 8

150 SERIES (HEAVY APPLICATIONS)

GRIP: HARDWOOD WITH SLEEVES (SLV)

MOUNT: STRAIGHT (S)

MOUNT MATERIAL: STAINLESS STEEL 304 (S4)

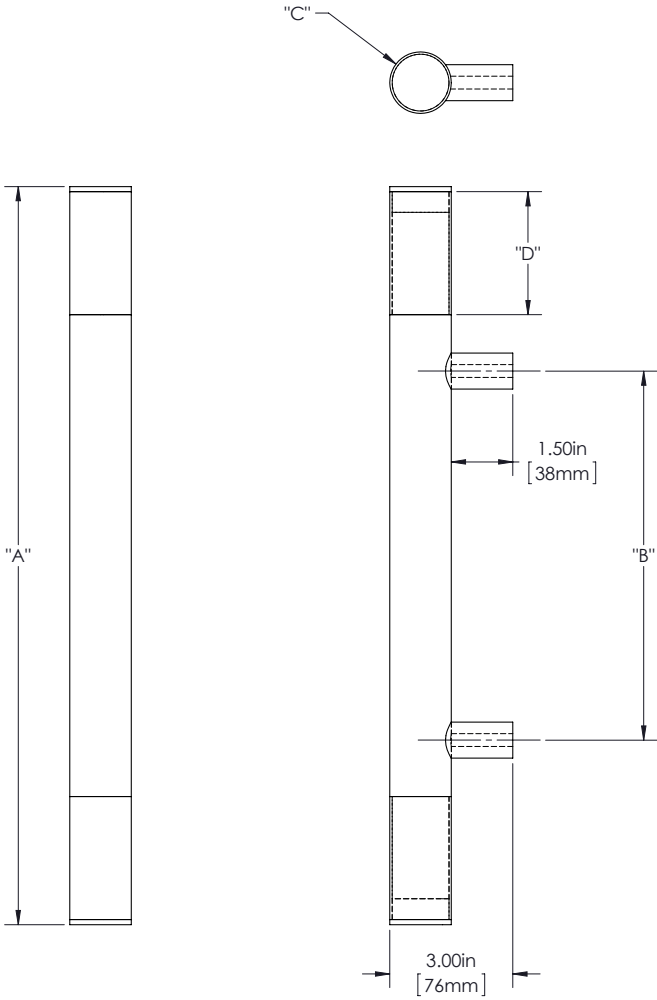

**Product Description:**  
1 1/2" Solid Round Wood Grip with Sleeves and Straight Round Mounts

**Material:**  
Grip - Hardwood  
Mount(s) - Stainless Steel

**Finish Description:**  
Grip - Cherry, Bubinga, Ipe, Jatoba, Mahogany, White Oak, Teak, Black Walnut  
Mount(s) - US32D, BSS Brushed Stainless; US32, PSS Polished Stainless; US19, MBK Matte Black PC; US10B, LTH Lithonia PC

Overall Length "A"	Center To Center "B"	Overall Diameter "C"	Sleeve Length "D"
18"(457mm)	9"(229mm)	1 1/2"(38mm)	1 1/2"(38mm)
24"(610mm)	15"(381mm)	1 1/2"(38mm)	3"(76mm)
36"(914mm)	24"(610mm)	1 1/2"(38mm)	3"(76mm)
48"(1219mm)	36"(914mm)	1 1/2"(38mm)	3"(76mm)

Custom sizes & finishes available upon request.

Dimensions are approximate and provided for reference purposes only