

SINTRA SNA

150 SERIES (HEAVY APPLICATIONS)

GRIP: SMOOTH (SMT)

MOUNT: STRAIGHT (S)

MOUNT MATERIAL: STAINLESS STEEL 305 (S4)

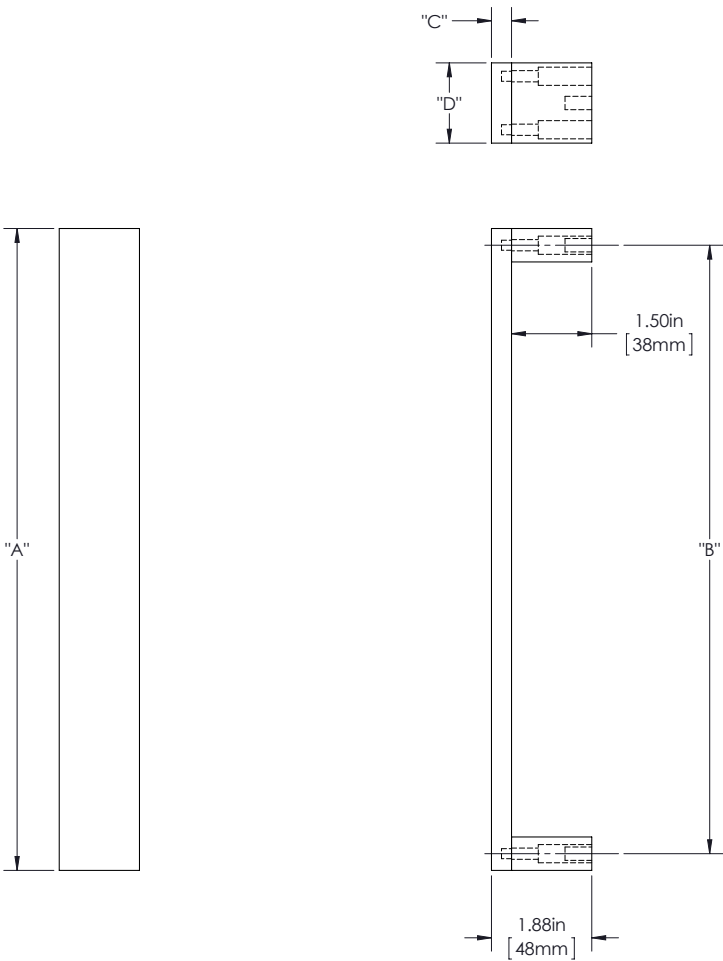

**Product Description:**  
5/8" Solid Ruler Grip with 1 1/2" Face and Straight Flat Square Mounts

**Material:**  
Stainless Steel

**Finish Description:**  
US32D, BSS Brushed Stainless; US32, PSS Polished Stainless;  
US19, MBK Matte Black PC; US10B, LTH Lithonia PC

Custom sizes & finishes available upon request.  
\*Recommended 3rd additional bracket for longer length.

Overall Length "A"	Center To Center "B"	Thickness "C"	Face Width "D"
12"(305mm)	11 3/8"(289mm)	5/8"(16mm)	1 1/2"(38mm)
24"(610mm)	23 3/8"(594mm)	5/8"(16mm)	1 1/2"(38mm)
36"(914mm)	35 3/8"(899mm)	5/8"(16mm)	1 1/2"(38mm)
48"(1219mm)	47 3/8"(1203mm)	5/8"(16mm)	1 1/2"(38mm)
60"(1524mm)	59 3/8"(1508mm)	5/8"(16mm)	1 1/2"(38mm)
72"(1829mm)	71 3/8"(1813mm)	5/8"(16mm)	1 1/2"(38mm)
84"(2134mm)	83 3/8"(2118mm)	5/8"(16mm)	1 1/2"(38mm)
*96"(2438mm)	95 3/8"(2423mm)	5/8"(16mm)	1 1/2"(38mm)
*108"(2743mm)	107 3/8"(2727mm)	5/8"(16mm)	1 1/2"(38mm)

Dimensions are approximate and provided for reference purposes only

SINTRA

SNA

150 SERIES (HEAVY APPLICATIONS)

GRIP: SMOOTH (SMT)

MOUNT: STRAIGHT (S)

MOUNT MATERIAL: BRASS (BR)

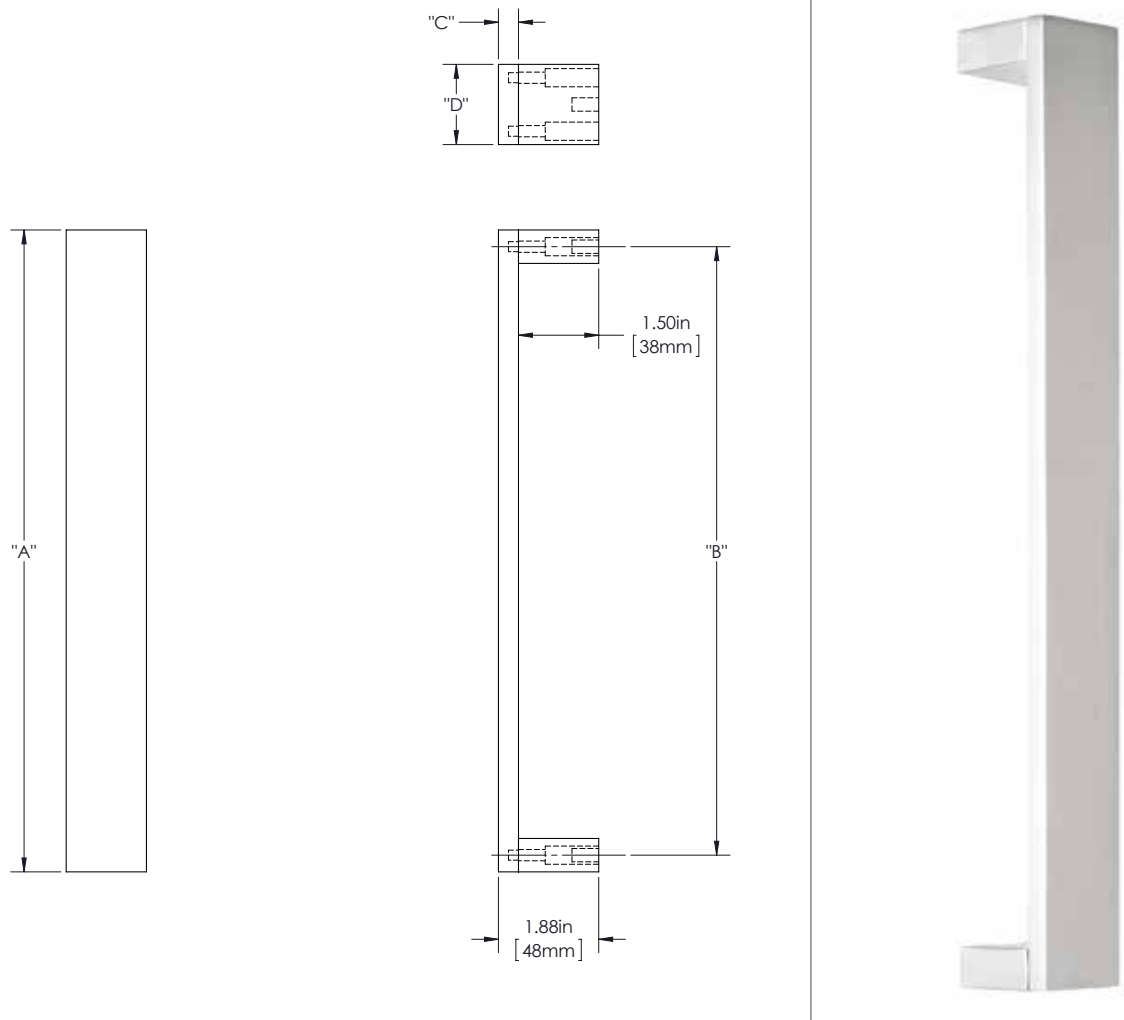

**Product Description:**  
5/8" Solid Ruler Grip with 1 1/2" Face and Straight Flat Square Mounts

**Material:**  
Brass

**Finish Description:**  
US11, AGB Aged Brass; US5, ATB Antique Brass; US3, PLB Polished Brass; US4, SNB Satin Brass; US10B, ORB Oil Rubbed Bronze; US26, PLC Polished Chrome; US15, SNB Satin Nickel; US19, MBK Matte Black PC; US10B, LTH Lithonia PC

Custom sizes & finishes available upon request.  
\*Recommended 3rd additional bracket for longer length.

Overall Length "A"	Center To Center "B"	Thickness "C"	Face Width "D"
12"(305mm)	11 3/8"(289mm)	5/8"(16mm)	1 1/2"(38mm)
24"(610mm)	23 3/8"(594mm)	5/8"(16mm)	1 1/2"(38mm)
36"(914mm)	35 3/8"(899mm)	5/8"(16mm)	1 1/2"(38mm)
48"(1219mm)	47 3/8"(1203mm)	5/8"(16mm)	1 1/2"(38mm)
60"(1524mm)	59 3/8"(1508mm)	5/8"(16mm)	1 1/2"(38mm)
72"(1829mm)	71 3/8"(1813mm)	5/8"(16mm)	1 1/2"(38mm)
84"(2134mm)	83 3/8"(2118mm)	5/8"(16mm)	1 1/2"(38mm)
*96"(2438mm)	95 3/8"(2423mm)	5/8"(16mm)	1 1/2"(38mm)
*108"(2743mm)	107 3/8"(2727mm)	5/8"(16mm)	1 1/2"(38mm)

SINTRA SNA

- 150 SERIES (HEAVY APPLICATIONS)
- GRIP: SMOOTH (SMT)
- MOUNT: STRAIGHT (S)
- MOUNT MATERIAL: ALUMINUM (AL)

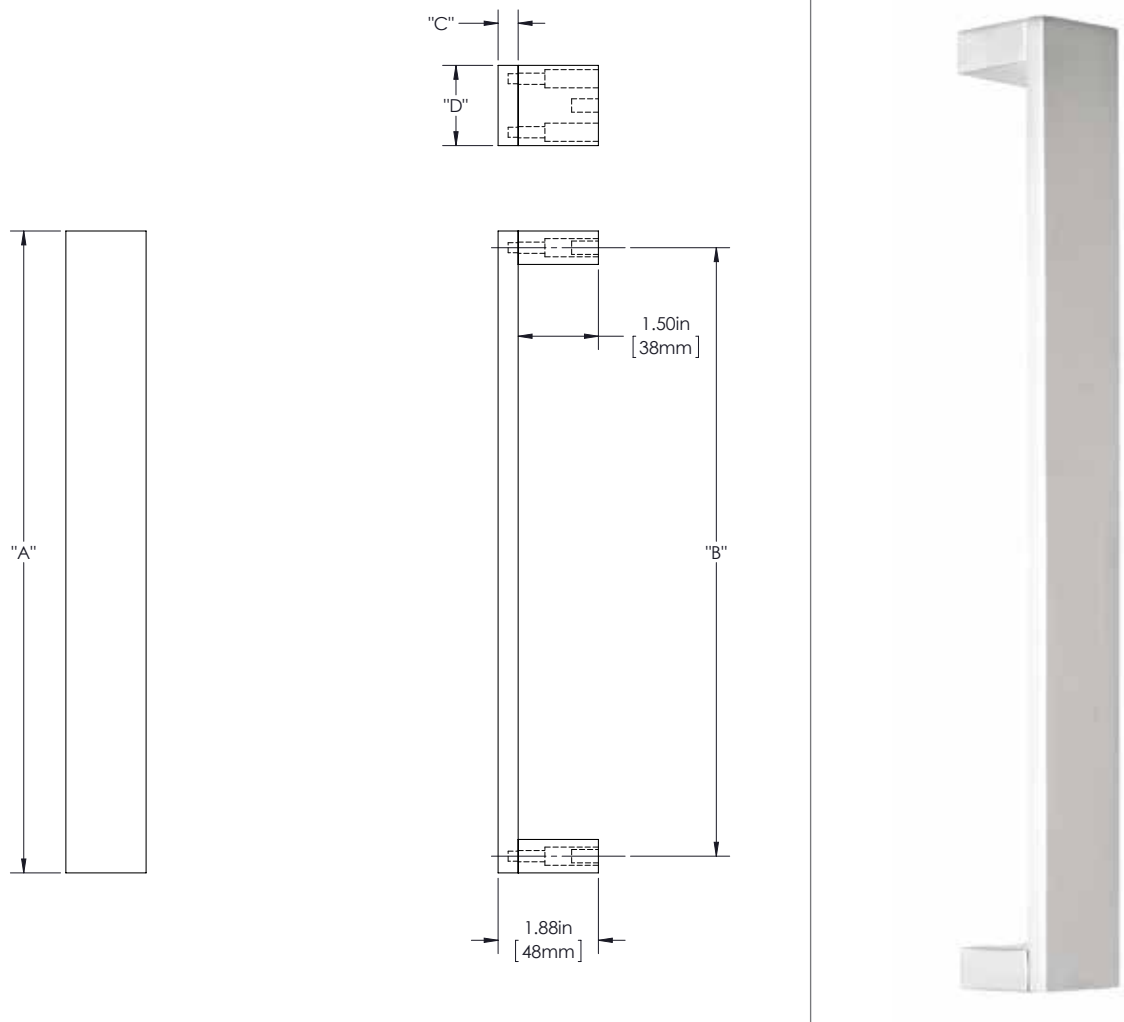

**Product Description:**  
5/8" Solid Ruler Grip with 1 1/2" Face and Straight Flat Square Mounts

**Material:**  
Aluminum

**Finish Description:**  
Mount(s) - US 28, BAL Brushed Aluminum, US19, MBK Matte Black PC; US10B, LTH Lithonia PC

Custom sizes & finishes available upon request.  
\*Recommended 3rd additional bracket for longer length.

Overall Length "A"	Center To Center "B"	Thickness "C"	Face Width "D"
12"(305mm)	11 3/8"(289mm)	5/8"(16mm)	1 1/2"(38mm)
24"(610mm)	23 3/8"(594mm)	5/8"(16mm)	1 1/2"(38mm)
36"(914mm)	35 3/8"(899mm)	5/8"(16mm)	1 1/2"(38mm)
48"(1219mm)	47 3/8"(1203mm)	5/8"(16mm)	1 1/2"(38mm)
60"(1524mm)	59 3/8"(1508mm)	5/8"(16mm)	1 1/2"(38mm)
72"(1829mm)	71 3/8"(1813mm)	5/8"(16mm)	1 1/2"(38mm)
84"(2134mm)	83 3/8"(2118mm)	5/8"(16mm)	1 1/2"(38mm)
*96"(2438mm)	95 3/8"(2423mm)	5/8"(16mm)	1 1/2"(38mm)
*108"(2743mm)	107 3/8"(2727mm)	5/8"(16mm)	1 1/2"(38mm)

Dimensions are approximate and provided for reference purposes only